



# Ejector pins Type CH

**through-hardened**  
- with cylindrical head and  
shouldered shaft

## DIN ISO 8694

(former DIN 1530 Part 2)

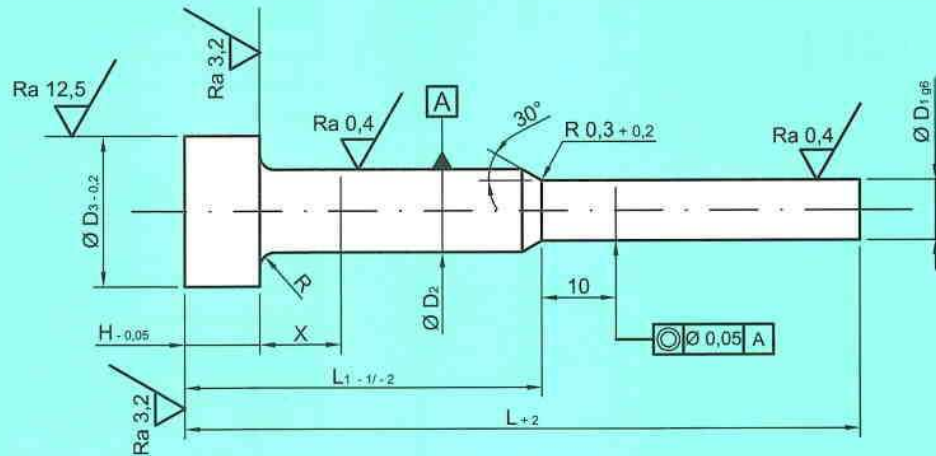

Dimension X: In this range small swelling possible.  
All edges without burr.

### Application

For demoulding of parts from compression- and injection moulds. Suitable for processing of plastics and metal alloys with low melting point. Shouldered pins are available with smallest shoulder diameter of 0,50 mm. Especially suitable for very tiny mouldings.

### Dimensions

Refer to chart overleaf - all dimensions are shown in "mm".

### Tolerances

Shoulder diameter  $D_1$

	0,80 - 2,50 $\varnothing$
g6	- 0,002
	- 0,008

Shaft diameter  $D_2 - 0,1$

Length: Overall  $L + 2$   
Shaft  $L_1 - 1/ - 2$

Other tolerances please refer to drawing and chart.  
Untoleranced dimensions according to DIN ISO 2768-m.

### Material

Alloyed cold working steel (WS)  
Material-No. 1.2516 (120 WV 4)  
1.2067 (100 Cr 6)

### Characteristic

Tempering properties approx. 200° C / 392° F

### Hardness

Shaft/shoulder: HRC 60  $\pm 2$   
Head: HRC 45  $\pm 5$  (1250 - 1670 MPa)

### Finish

Trough-hardened, tempered, fine ground shaft and shouldered portion, hot forged cylindrical head, conserved.

### Remarks

The shouldered ejector pins are also available with bigger shaft diameters and shouldered portion diameter.

**Chart**

**Item No. AC01**

Shoulder-Ø	Shaft-Ø	Head-Ø	Head height	Radius	63 (60)* 25 (25)* 38 (35)*	80 32 (35)* 48 (45)*	100 50 50	125 50 75	160 63 (75)* 97 (85)*	200 80 (75)* 120 (125)*	250 100 150	Overall length L +2 Shaft length L <sub>1</sub> -1/-2 approx. length of shouldered portion			
D <sub>1</sub> g6	D <sub>2</sub> -0,1	D <sub>3</sub> -0,2	H -0,05	R +0,2											
0,8	2	4	2	0,2											
0,9															
1,0															
1,1															
1,2															
1,3															
1,4															
1,5					3	6	3	0,3							
1,6															
1,7															
1,8															
1,9															
2,0															
2,2															
2,5															

The marked squares indicate **DREI-S** standard sizes.

**Other sizes on request.**

\* On all lengths put in brackets stock keeping is running out, manufacturing only on request.