



Ejector pins Type AH

HSS

- with cylindrical head

similar to DIN ISO 6751

(former similar to DIN 1530 Part 1)

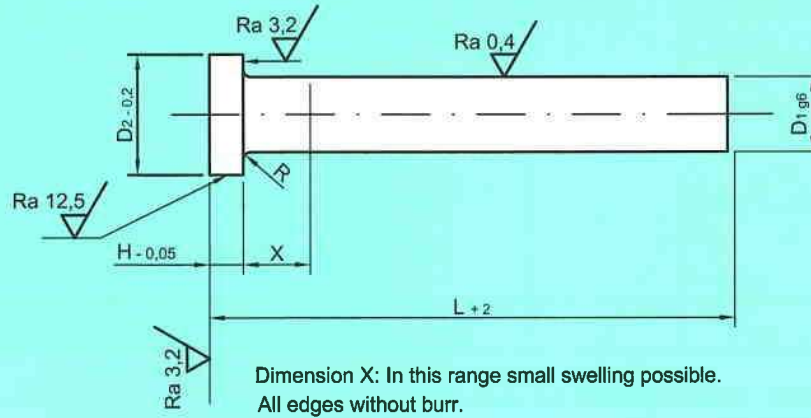

Application

For demoulding of abrasive plastics.
Extremely wear-resistant at hardest application.

Dimensions

Refer to chart overleaf - all dimensions are shown in "mm".

Tolerances

Shaft diameter D_1

	1,5 - 3 Ø	3,2 - 6 Ø	6,2 - 10 Ø
g 6	- 0,002	- 0,004	- 0,005
	- 0,008	- 0,012	- 0,014

Overall length $L + 2$

For other tolerances please refer to drawing and chart.
Untoleranced dimensions according to DIN ISO 2768-m.

Material

Material-No. 1.3343

Hardness

Shaft: HRC 60 ±1
Head: HRC 42 ±2

Finish

ground shaft, hot forged cylindrical head, through hardened.

Remarks

These ejector pins combine the wear resistance of a nitrided pin with the high core hardness of a hardened pin.
Especially suitable for later grinding of contours.

Chart

Item No. HA03

Shaft-Ø D ₁ g6	Head-Ø D ₂ -0,2	Head height H -0,05	Radius R +0,2	Overall length L + 2				
				100	125	160	200	250
1,5	3	1,5	0,2					
2,0	3 (4)	1,5 (2)						
2,2								
2,5	5	2	0,3					
3,0	6	3						
3,2								
3,5				7				
4,0	8							
4,2								
4,5								
5,0	10							
5,2								
5,5								
6,0	12	5	0,5					
8,0	14							
9,0								
10,0	16							

The marked squares indicate **DREI-S** standard sizes.
Other sizes on request.